

Pannelli in misure standard e finiti a misura.

Standard size and pre-finished panels in aluminium and steel.

Panneaux avec mesures standard et avec mesures finies.

Paneles estándar y a medida.

Standardgröße end einbaufertige Paneelen aus Aluminium und Stahl.

标准大小盘区和盘区完成对大小。

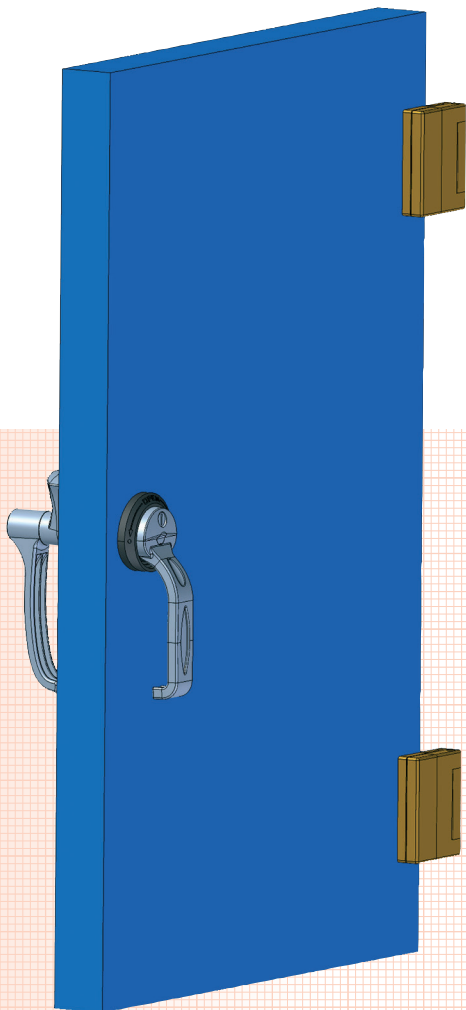

Sezione  
Section  
Section  
Sección  
Teil  
第03号

03

The available panels are:

**PTM:** They consist of two pre-painted silver aluminum sheets with a polystyrene core. The profile (P 191) is also available to cover the edge of the panel. These frame profiles must be cut to 45° in order to make them fit together.

The standard size is 1000x2000x25 mm.

**PANEL:** We supply expanded polyurethane panels in standard size of 1250x3020 mm and of variable thickness. These panels are made of aluminium or galvanised steel sheet and come in different colours.

These panels can be supplied with a PVC profiles to cover the edge of the panel.

**PANEL-B:** We create custom-made finished panels using press-bent sheet metal and a core of expanded polyurethane or rock wool. These panels are manufactured with various types of sheet metal and come in a variety of colors.

Panels' certificates and technical characteristics are available on request.

**PTM : PANELS WITH POLYSTYRENE CORE AND ALUMINIUM COAT - SILVER COLOUR**  
DIM 1000x2000x25 mm - 39,37x78,74x0,984 inch

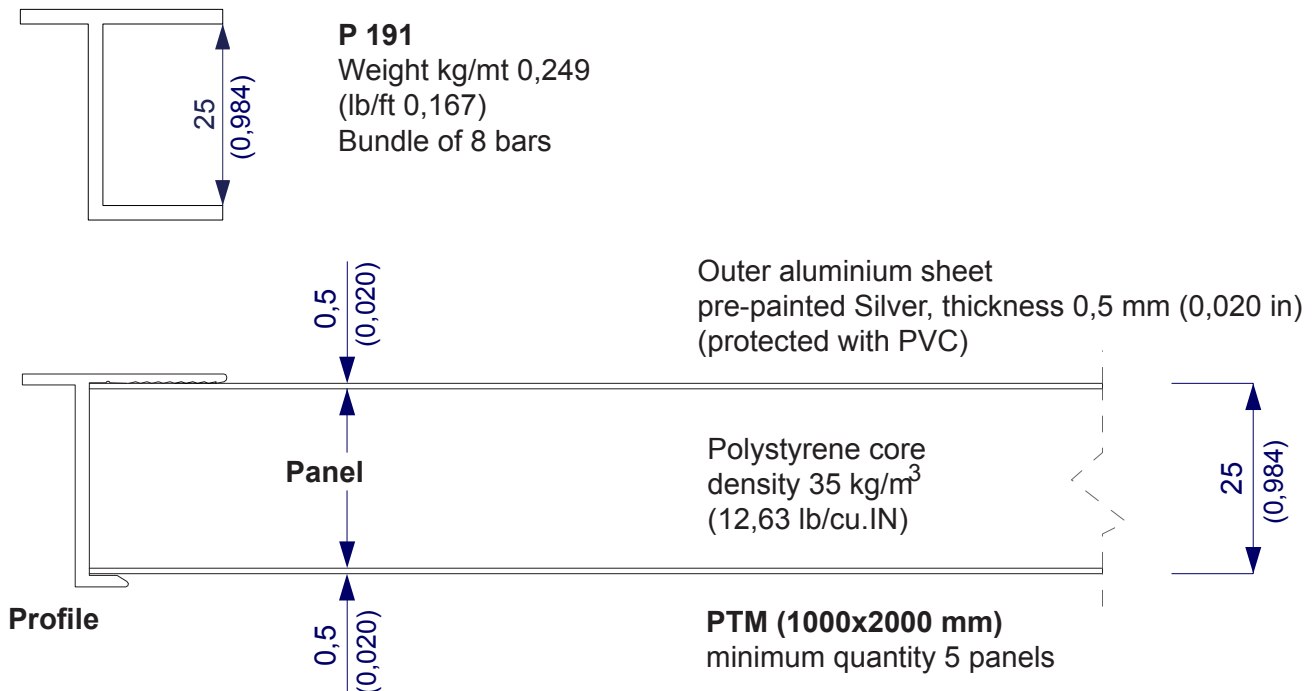

**TECHNICAL SPECIFICATION:**

<b>Fire resistance:</b>	flame retardant, homologated Class 1 ASTM 2962/68
<b>Operating temperature range:</b>	- 40° C + 85 ° C (9,7 F + 185,0 F)
<b>Moisture resistance:</b>	water absorption by capillarity: none
<b>Noise level measured:</b>	dB 72 ISO 717

**PANEL : PANELS WITH POLYURETHANE CORE , GALVANISED AND PLASTIFIED COAT**  
DIM 1250x3020x 25,45,50 mm - 49,213x118,90x0,984/1,772/1,968 inch.

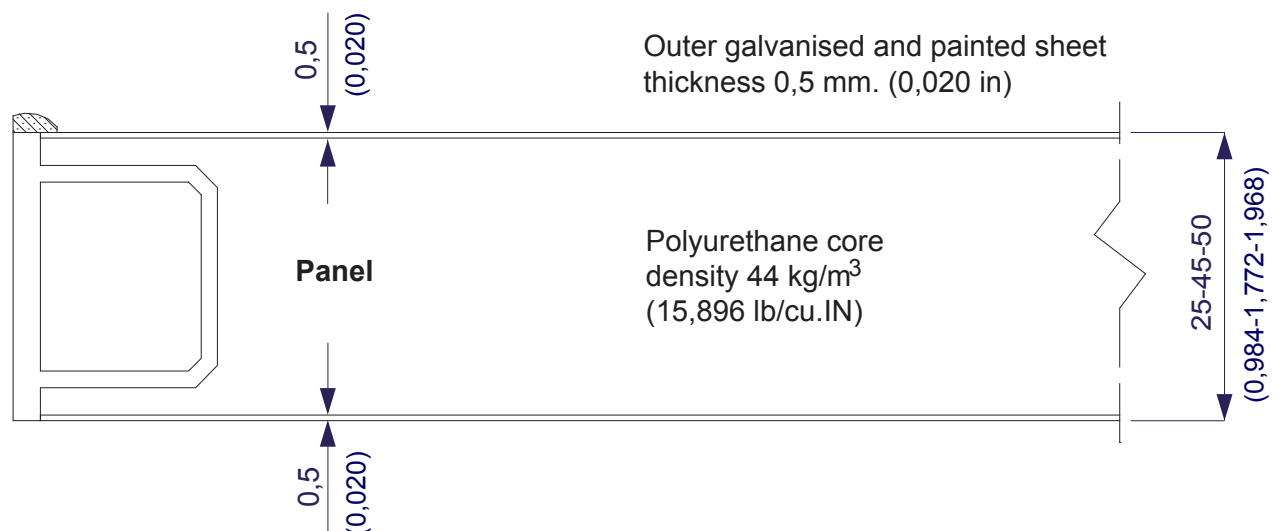

**Profiles for edging panels**

**PVC PANEL 25**

**PVC PANEL 45**

**PVC PANEL 50**

Minimum quantity: 10 bars - 62 mt

**PANEL (0.5 Galvanized / polyurethane / 0.5 Painted)**

**Panel 25 (1250x3020 mm)**

**Panel 45 (1250x3020 mm)**

**Panel 50 (1250x4000 mm)**

Minimum quantity 5 panels

**PANEL-B : CUSTOMIZED BENT PANELS WITH POLYUTRETHANE CORE,  
GALVANISED AND PLASTIFIED COAT**

**SINGLE BENT PANEL**

**PANEL-B**

Minimum quantity 5 panels

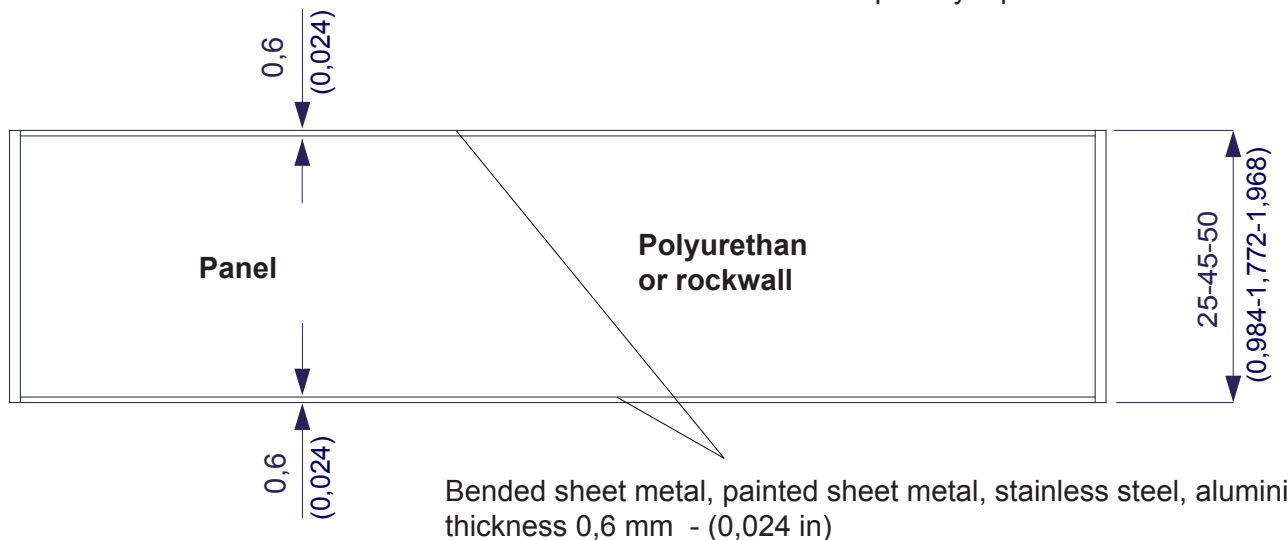

**DOUBLE BENT PANEL**

**PANEL-B**

Minimum quantity 5 panels

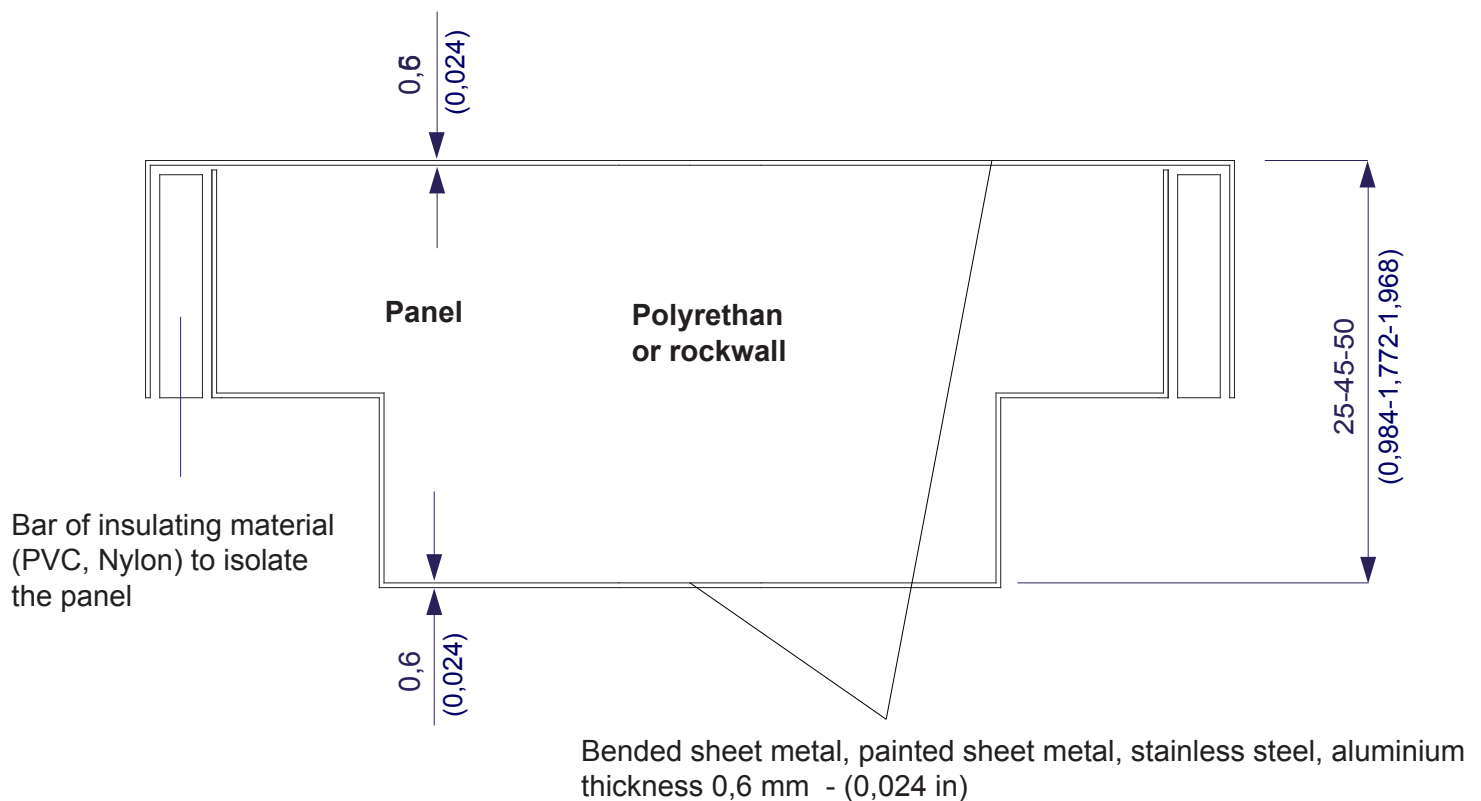

**PANEL-B : CUSTOMIZED BENT PANELS WITH POLYUTRETHANE CORE,  
GALVANISED AND PLASTIFIED COAT**

**SINGLE BENT PANEL  
Thickness 45**

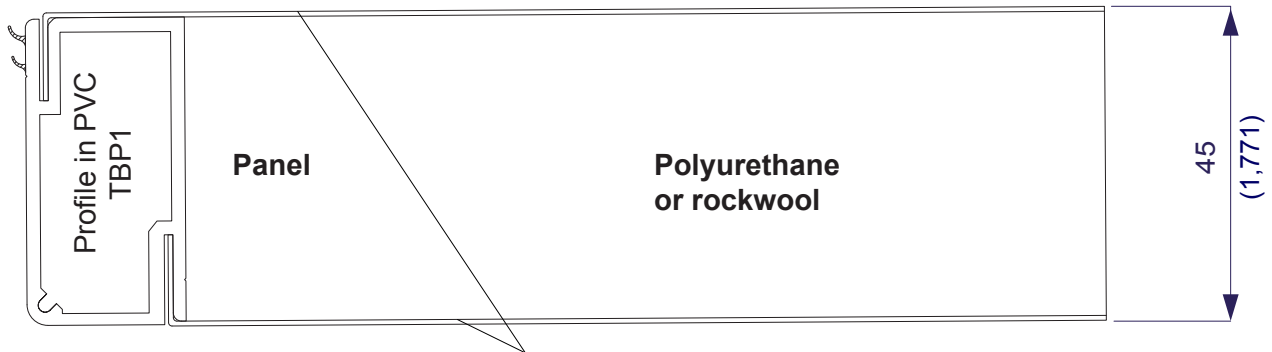

Bended sheet metal, painted sheet metal, stainless steel, aluminium  
thickness 0,6 mm - (0,024 in)

**SINGLE BENT PANEL  
Thickness 50**

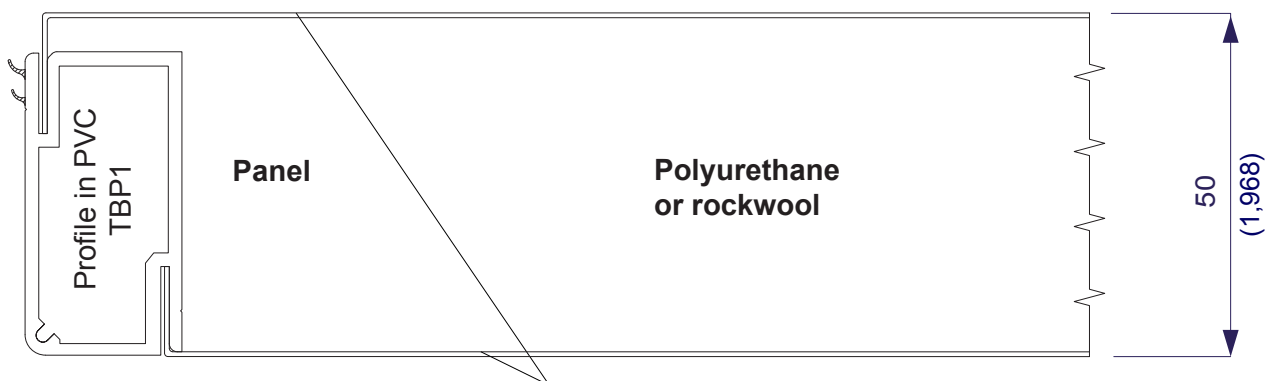

Bended sheet metal, painted sheet metal, stainless steel, aluminium  
thickness 0,6 mm - (0,024 in)

**DOUBLE BENT PANEL  
Thickness 62-75-80**

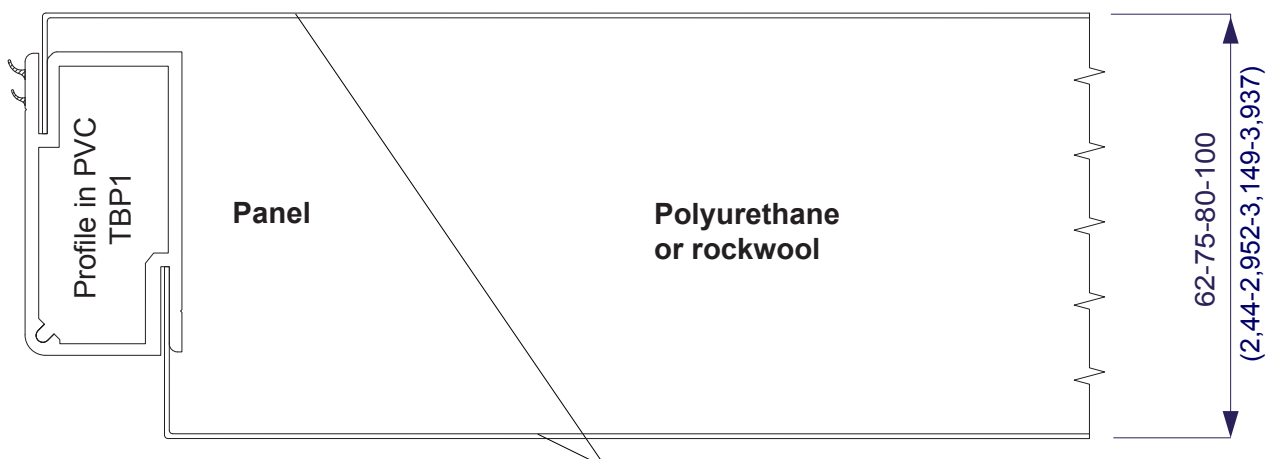

Bended sheet metal, painted sheet metal, stainless steel, aluminium  
thickness 0,6 mm - (0,024 in)

Other options available

**PANEL EXPLOSION**

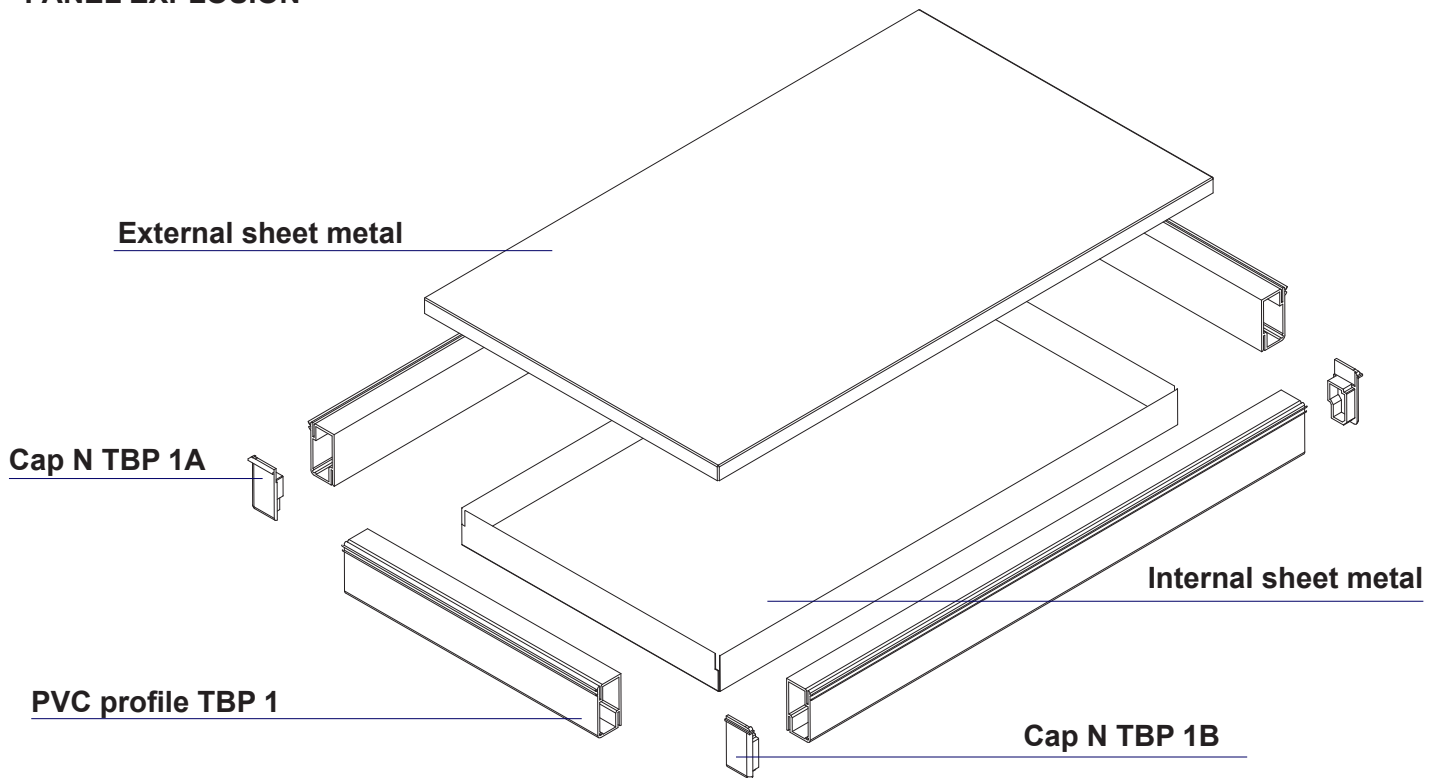

**ACCESSORIES AND COMPONENTS**

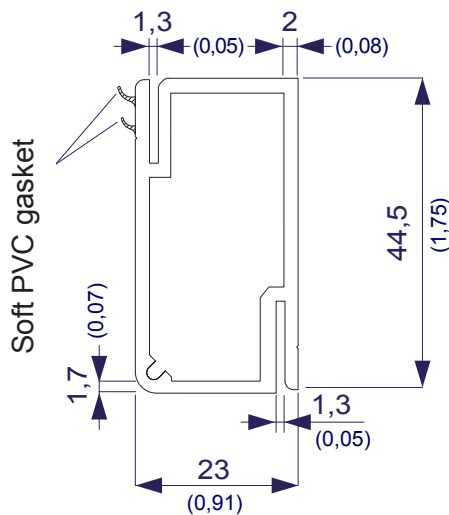

**TBP 1**  
Bundle of 5 bars

**TECHNICAL SPECIFICATION:**

- Fire resistance:** flame retardant, homologated Class 1 ASTM 2962/68
- Operating temperature range:** - 40° C + 85 ° C (9,7 F + 185,0 F)
- Moisture resistance:** water absorption by capillarity: none
- Noise level measured:** dB 72 ISO 717

**ACCESSORIES AND COMPONENTS**

**N TBP 1 A**  
Box of 100 pcs.

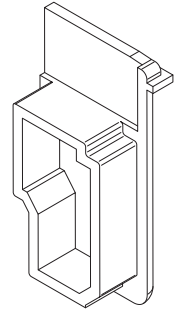
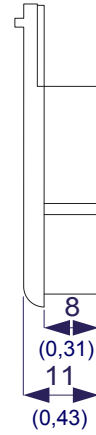
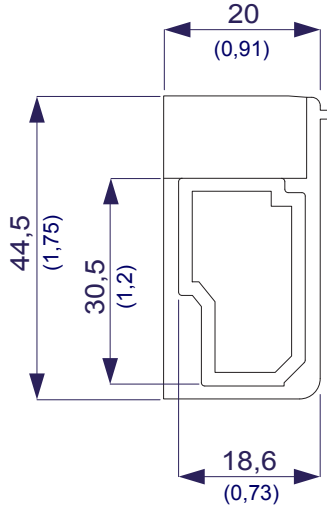

**N TBP 1 B**  
Box of 100 pcs.

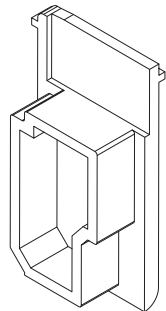
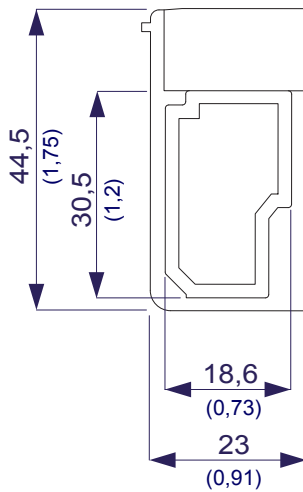

**Gaskets**

**G0017**  
Box of 250 mt.

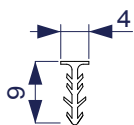

**G0020**  
Box of 250 mt.

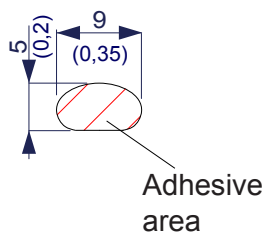

**G0021**  
Box of 250 mt.

